

## RamPlug™ Anchors

### Long expansion copes with hollow brickwork

Available in a variety of configurations, the RamPlug™ Anchor provides a medium duty screw anchoring point into concrete, hollow brick and for light duty applications in lightweight concrete.



### Specification

- The RamPlug™ Anchor is a light duty, rotation setting interference fit anchor. RamPlug™ Anchor is made of polyamide 6 (high resistance nylon)

### Substrates

- Concrete • Stone • Solid block • Solid brick
- Lightweight concrete (AAC) block

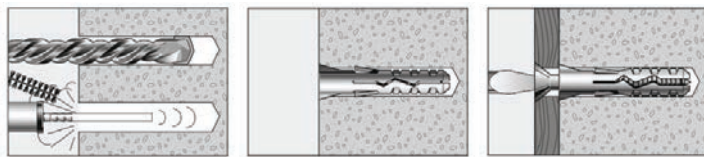

### Product Advantages

- Anti rotation barbs prevent the anchor from rotating in the hole
- Nylon sleeve reduces cold bridging compared with metal fixings
- Countersunk sleeve and screw allows flush finish
- Zinc plated drive screw for corrosion resistance (dry internal use)
- Nylon sleeve assists shear capacity
- Through fixing lowers in place cost

### Applications

- Wall plates
- Sole plates
- Battens
- Door and window frames

### Installation

1. Drill a hole of the correct diameter through the fixture to the minimum drilling depth given in the technical data table, blow out dust. If the fixture thickness is less than the maximum given in the table below, the hole depth has to be increased accordingly.
2. Position the anchor in the hole through the fixture using light hammer blows until the collar of the anchor makes contact with the part to be fixed.
3. Tighten using a screwdriver until the head of the screw is flush with the collar of the anchor.

### RamPlug™ Anchors - Standard (Installation and Loading Performance)



Part No.	Anchor Diameter (mm)	Overall Anchor Length (mm)	Hole Ø (mm)	Min Hole Depth (mm)	Screw Gauge	Order Qty	Recommended Working Load* (N)				
							Concrete 30N/mm <sup>2</sup>	Solid Brickwork 20N/mm <sup>2</sup>	Cavity Bricks 20N/mm <sup>2</sup>	Light Construct Walls 8N/mm <sup>2</sup>	Light Construct Walls 4N/mm <sup>2</sup>
DNP05	5	25	5	30	5 - 7	100	300	300	200	80	40
DNP06	6	30	6	40	6 - 9	100	500	500	250	120	80
DNP07	7	30	7	40	9 - 12	100	650	650	320	155	100
DNP08	8	40	8	50	10 - 14	100	800	800	350	200	150
DNP10	10	50	10	60	14 - 18	50	1200	1100	450	350	200
DNP12	12	60	12	75	18 - 24	25	1800	1500	550	500	250

\* Screw not supplied

### RamPlug™ Anchors - Long Plug (Installation and Loading Performance)



Part No.	Anchor Diameter (mm)	Overall Anchor Length (mm)	Hole Ø (mm)	Min Hole Depth (mm)	Screw Gauge	Order Qty	Recommended Working Load* (N)			
							Perforated Bricks 20N/mm <sup>2</sup>	Cavity Bricks 20N/mm <sup>2</sup>	Light Construct Walls 8N/mm <sup>2</sup>	Light Construct Walls 4N/mm <sup>2</sup>
DLP08	8	80	8	90	10 - 14	100	450	350	300	200
DLP10	10	80	10	90	14 - 18	50	550	400	450	250

\* Screw not supplied

### RamPlug™ Anchors - Ultra Long plug (Installation and Loading Performance)



Part No.	Anchor Diameter (mm)	Max Fixture Thickness (mm)	Overall Anchor Length (mm)	Hole Ø (mm)	Min Hole Depth (mm)	Min Embedment Depth (mm)	Head Style	Order Qty	Recommended Working Load* (N)				
									Soild Brick	Concrete Brick	Perforated Cavity	Concrete Block	Concrete Solid Block
DUP10080F	10	10	80	10	90	80	Countersunk	25	600	800	300	250	250
DUP10080H	10	10	80	10	90	80	Hex	25	600	800	300	250	250
DUP10100F	10	10	100	10	100	90	Countersunk	25	600	800	300	250	250
DUP10100H	10	10	100	10	100	90	Hex	25	600	800	300	250	250
DUP10135F	10	45	135	10	100	90	Countersunk	25	600	800	300	250	250
DUP10135H	10	45	135	10	100	90	Hex	25	600	800	300	250	250
DUP10160F	10	70	160	10	100	90	Countersunk	25	600	800	300	250	250
DUP10160H	10	70	160	10	100	90	Hex	25	600	800	300	250	250

\* Supplied complete with screws

# Safety factor of minimum 3 included

## HIT-M Hammer-In Anchors

### Hammer-In Anchors

A high quality, excellent performance lightweight anchor with ETA approval that is easy and quick to set.



### Specification

- HIT-M is a hammer-in, polyamide lightweight anchor which is versatile to be used in various types of base material.

### Substrates

- Concrete • Solid block stone • Solid brick • Solid brick
- Aerated concrete • Plasterboard-dry partition walls
- Hollow block wall • Hollow brick • Hollow floor beam

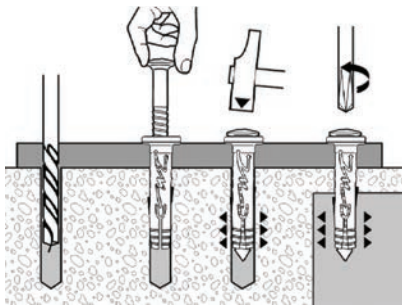

### Product Advantages

- Easy to install through part to be fixed
- Expands by hammering or screwing (possible to be removed)
- Made of polyamide 6 (highly resistant nylon)
- Wide collar ensures tight fixing
- M slot and specific design improves the expansion in all kinds of materials, even in plasterboard

### Applications

- Substructure protections
- Facade insulations
- Claddings
- Trunks & cable rails
- Doors & window frames
- Skirting
- Electrical shutter rails
- Roof flashings
- Water heaters collars

### Installation

- Drill the correct diameter hole.
- Insert the anchor into the hole.
- For solid base material, hammer the expansion nail to obtain the complete setting of the anchor and until the head of the nail comes into contact with the flange of the sleeve.
- For hollow base material, expand by screwing with screw driving machine and suitable pozidrive bit.

### HIT-M Hammer-In Anchors - Recommended Working Loads

Anchor Size	Embedment Depth (mm)	Plasterboard Type BAB		Aerated Concrete ( $M_{VN} = 500\text{kg/m}^3$ )		Clay Bricks ( $f_c = 55\text{N/mm}^2$ )		Concrete $25\text{N/mm}^2$	
		Shear (kN)*	Tensile (kN)*	Shear (kN)*	Tensile (kN)*	Shear (kN)*	Tensile (kN)*	Shear (kN)*	Tensile (kN)*
5-5	20	0.05	0.05	0.05	0.05	0.625	0.4	0.625	0.225
5-15	20	0.05	0.05	0.05	0.05	0.625	0.4	0.625	0.225
6-5	25	0.05	0.05	0.06	0.06	0.938	0.65	0.938	0.375
6-12	25	0.05	0.05	0.06	0.06	0.938	0.65	0.938	0.375
6-25	25	0.05	0.05	0.06	0.06	0.938	0.65	0.938	0.375
6-40	25	0.05	0.05	0.06	0.06	0.750	0.65	0.750	0.375
8-10	30	0.063	0.063	0.105	0.105	1.438	0.9	1.438	0.525
8-30	30	0.063	0.063	0.105	0.105	1.438	0.9	1.438	0.525
8-60	30	0.063	0.063	0.105	0.105	1.438	0.9	1.438	0.525
8-80	30	0.063	0.063	0.105	0.105	1.188	0.9	1.188	0.525
8-100	30	0.063	0.063	0.105	0.105	1.188	0.9	1.188	0.525

\* Safety factor of minimum 3 included

**HIT-M Hammer-In Anchors - P Head Version**



Part No.	Description	Max. Fixture Thickness (mm)	Overall Anchor Length (mm)	Drilled Hole Ø (mm)	Min Hole Depth (mm)	Order Qty
050116	HIT-M 5-5/27 P	5	27	5	30	200
050117	HIT-M 5-15/37 P	15	37	5	30	200
050118	HIT-M 6-5/32 P	5	32	6	35	200
050119	HIT-M 6-12/39 P	12	39	6	35	100
050121	HIT-M 6-25/52 P	25	52	6	35	100
050122	HIT-M 6-40/67 P	40	67	6	35	100
050123	HIT-M 8-10/42 P	10	42	8	40	100
050124	HIT-M 8-30/62 P	30	62	8	40	100
050125	HIT-M 8-60/92 P	60	92	8	40	100
050126	HIT-M 8-80/112 P	80	112	8	40	100
050127	HIT-M 8-100/132 P	100	132	8	40	100

**HIT-M Hammer-In Anchors - V Head Version**



Part No.	Description	Max. Fixture Thickness (mm)	Overall Anchor Length (mm)	Drilled Hole Ø (mm)	Min Hole Depth (mm)	Order Qty
050129	HIT-M 6-12/39 V	12	39	6	35	100
050131	HIT-M 6-25/52 V	25	52	6	35	100
050132	HIT-M 6-40/67 V	40	67	6	35	100
050134	HIT-M 8-30/62 V	30	62	8	40	100
050135	HIT-M 8-60/92 V	60	92	8	40	100
050136	HIT-M 8-80/112 V	80	112	8	40	100
050137	HIT-M 8-100/132 V	100	132	8	40	100

**HIT-M Hammer-In Anchors - Stainless Steel A2**



Part No.	Description	Max. Fixture Thickness (mm)	Overall Anchor Length (mm)	Drilled Hole Ø (mm)	Min Hole Depth (mm)	Order Qty
055347	HIT-M 6-5/32 P A2	5	32	6	35	200
055348	HIT-M 6-25/52 P A2	25	52	6	35	100
055349	HIT-M 6-40/67 P A2	40	67	6	35	100
055355	HIT-M 8-10/42 P A2	10	42	8	40	100
055356	HIT-M 8-30/62 P A2	30	62	8	40	100
055357	HIT-M 8-60/92 P A2	60	92	8	40	100

**HIT-M Hammer-In Anchors - Special Version**



Part No.	Description	Max. Fixture Thickness (mm)	Overall Anchor Length (mm)	Drilled Hole Ø (mm)	Min Hole Depth (mm)	Order Qty
<b>Nylon Screw</b>						
050139	HIT-M 5-5/27 CN Nylon version	5	27	5	30	200
<b>Threaded Head</b>						
050141	HIT-M 6-5-M6x100	5	32	6	40	100
050142	HIT-M 6/5-M7x150 Threaded	5	32	6	40	100

## PRO 6 Universal Anchor

### Universal Anchor suitable for all material types

High performance hollow base material nylon anchor. Efficient light weight anchor with six expandable zones for effective anti-rotation in most base materials.



### Product Advantages

- Special collar allows through fixing
- Made of polyamide 6 (highly resistant nylon)
- Oversized body for high performance in solid base materials
- Unique innovative and patented six expandable zones that prevents rotation

### Applications

- Kitchen fittings
- Electrical accessories
- Toilet fitting
- Wash basins
- Picture fittings

### Installation

1. Drill the correct diameter hole.
2. Insert the anchor into the hole – through fixture.
3. Using a screwdriver, screw the fixing to give clamping action.

### Specification

- Once fully pushed through the pre-drilled hole the spring wings automatically expand in the void. Tightening the screw pulls the wings towards the inner face of the cavity creating a clamping fixing.

### Substrates

- Concrete • Solid block • Solid stone • Solid brick • Hollow block
- Aerated concrete • Hollow slab • Hollow brick • Hardie wall
- Typical drywall (HKHA)

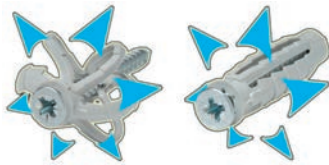
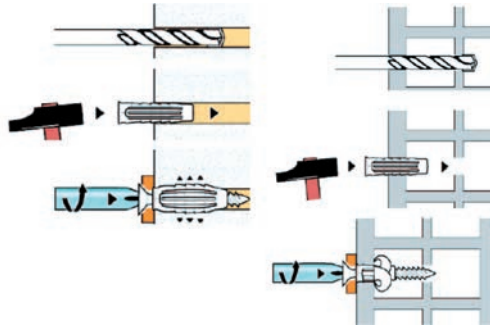

### PRO 6 Universal Anchor - Recommended Working Load<sup>1</sup> with Wood Screw

Anchor Size	Ø Woodscrew (mm)	Concrete (≥ C20/25) (kN)	Hollow Concrete Block (B40) (kN)	Clay Brick (BP 400) (kN)	Hollow Clay Brick (Eco 40) (kN)
5x25	4	0.28	0.23	0.20	0.17
6x30	5	0.45	0.30	0.26	0.19
8x40	6	0.70	0.43	0.35	0.23
10x50	8	1.20	0.46	0.60	0.25
12x60	8	1.50	0.52	0.80	0.30
14x70	10	2.10	0.56	0.90	0.36

\* Safety factor of minimum 3 included

### PRO 6 Universal Anchor - with Screw

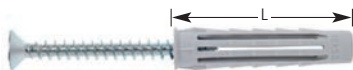

Part No.	Description	Overall Anchor Length (L) (mm)	Drilled Hole Ø (mm)	Min Hole Depth (mm)	Order Qty
565646	PRO6 5x25 with screw	25	5	35	100
565647	PRO6 6x30 with screw	30	6	40	100
565648	PRO6 8x40 with screw	40	8	50	50
565649	PRO6 10x50 with screw	50	10	65	25

### PRO 6 Universal Anchor - without Screw

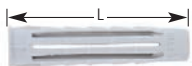

Part No.	Description	Min. and Max. Ø Screw (mm)	Min Screw Length (mm)	Overall Anchor Length (L) (mm)	Drilled Hole Ø (mm)	Min Hole Depth (mm)	Order Qty
565642	PRO6 5x25 without screw	3 - 4	30	25	5	35	100
565643	PRO6 6x30 without screw	4 - 5	40	30	6	40	100
565644	PRO6 8x40 without screw	4.5 - 6	50	40	8	50	100
565645	PRO6 10x50 without screw	6 - 8	60	50	10	65	50
565617	PRO6 12x60 without screw	8 - 10	70	60	12	75	25
565618	PRO6 14x70 without screw	10 - 12	80	70	14	85	20

## CC Hollow Wall Anchors

### Pre-assembled cavity fixing

High load metal fixing that can suit different partition



#### Substrates

- Hollow block
- Hollow floor slab
- Hollow brick
- Plasterboard
- Hardie Wall

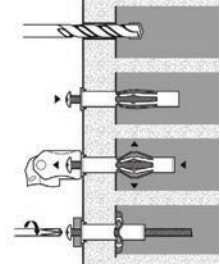

### CC Hollow Wall Anchor (Installation and Loading Performance)

Part No.	Description	Thread Size	Anchor Length (mm)	Min/Max Wall Thickness (mm)	Hole Ø (mm)	Fixture Thickness (mm)	Order Qty	Recommended Working Load* (kN) in 10mm Plasterboard
061030	CC4-6/23	M4	23	2 / 6	8	10-15	100	0.12
061040	CC4-13/33	M4	33	4 / 13	8	10-20	100	0.12
061050	CC4-24/46	M4	46	12 / 24	8	10-20	100	0.12
061070	CC5-14/34	M5	34	6 / 14	8	10-20	100	0.18
061080	CC5-16/45	M5	45	3 / 16	8	10-25	100	0.18
061090	CC5-32/59	M5	59	14 / 32	8	10-25	100	0.18
061110	CC6-13/34	M6	34	6 / 13	10	10-20	100	0.22
061120	CC6-16/46	M6	46	4 / 16	10	10-25	100	0.22
061130	CC6-30/59	M6	59	16 / 30	10	10-25	100	0.22
318600	Hand Gun Type Setting Tool						1	

\* Safety factor of minimum 3 included

#### Product Advantages

- Flush finish low profile head
- Large flange prevents pull into base material
- Anti rotation barbs prevent spinning in the hole
- Can be set with a setting tool or by using a screwdriver for smaller sizes
- 5 expansion legs give full support (M5 and M6)

#### Applications

- Bathroom fixtures
- Kitchen fixtures
- Shelving brackets
- Ceiling fixtures

#### Installation

1. Drill the recommended sized hole through the material then tap the anchor into the hole until it is flush with the surface.
2. Attach anchor setting tool to screw and expand the anchor. Small sizes may be set using a screwdriver.
3. Remove the screw and place through the hole in the fixture then back into the hollow wall anchor and tighten the screw.

## RamToggle™ - Nylon Cavity Fastener

### Nylon Cavity Fastener

One piece light duty nylon cavity fastener



#### Specification

- Temperature resistance up to 80°C in service

#### Substrates

- Hollow block
- Solid block
- Plasterboard

#### Solid Installation



#### Cavity Installation

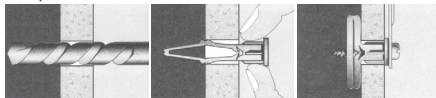

### RamToggle™ - Light Duty Nylon Cavity Fastener

Part No.	Fastened Material (mm)	Hole Ø (mm)	Screw Length Cavity (mm)	Screw Length Solid (mm)	Screw Gauge/Size	Wall Thickness (mm)	Order Qty	Recommended Working Load* (kN) in 10mm Plasterboard
RT10	10	8	30	15	6-8 (4mm)	5-10	100	0.11
RT12	12	8	35	20	6-8 (4mm)	8-12	100	0.12
RT16	16	8	40	25	6-8 (4mm)	12-18	100	0.12

\* Safety factor of minimum 3 included

#### Product Advantages

- Suitable for cavity and solid wall applications
- Wide wing span for maximum holding power
- Anti rotation fins
- Nylon body is non-conductive

#### Applications

- Curtain tracks
- Cupboard hooks
- Notice board / picture

#### Installation

##### Solid Installation

1. Drill correct size hole.
2. Cut the wings at the "elbow" joint.
3. Push the cut wings together, insert into the hole. Tap home with a hammer, insert the screw through the fixture and tighten.

##### Cavity Installation

1. Drill the correct size hole through plasterboard, etc.
2. Compress wings of the Ramtoggle and insert it into the hole. Tap with a hammer to ensure flush with the surface.
3. Insert the screw through the fixture, into the Ramtoggle and tighten.

## Wire Hanger P6

**Ideal for fixing suspended ceilings**

A one piece all metal load assisted suspension anchor



### Substrates

- Concrete

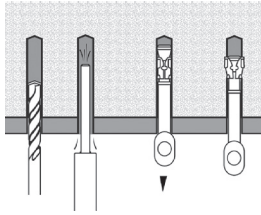

### Wire Hanger (Installation and Loading Performance in 40N/mm<sup>2</sup> Concrete)

Part No.	Description	Anchor Diameter (mm)	Anchor Length (mm)	Eye Diameter (mm)	Min Hole Depth (mm)	Order Qty	Embedment Depth (mm)	Tensile Load (kN)*	Shear Load (kN)*
FIX P6	Wire Hanger P6	6	64	6.2	35	100	25	1.8	1.7

\* Safety factor of minimum 3 included

### Product Advantages

- Gravity assisted, self expanding suspension anchor
- Improved fire resistance compared with plastic anchors

### Applications

- Fixing cables for suspended ceiling applications

### Installation

1. Drill a 6mm hole to the drilling depth given in the product range table.
2. Clean hole with hand pump.
3. Position the anchor in the hole. Tap in until the anchor can go no further.
4. Setting of the anchor can be achieved using the claw of a claw hammer.

## G8 Ceiling Anchor

**Ideal for fixing suspended ceilings**

A one piece all metal load assisted suspension anchor.

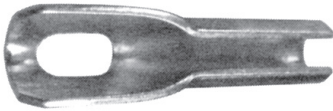

### Substrates

- Concrete

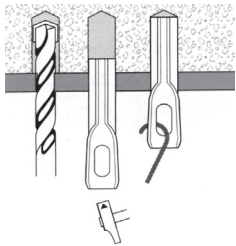

### G8 Ceiling Anchor (Installation and Loading Performance in 40N/mm<sup>2</sup> Concrete)

Part No.	Description	Anchor Length (mm)	Drilled Dia (mm)	Drilling Depth (mm)	Order Qty	Embedment Depth (mm)	Tensile Load (kN)*
G8	G8 Ceiling Anchor	43	8	25	100	21	0.7

\* Safety factor of minimum 3 included

### Product Advantages

- Gravity assisted, self expanding suspension anchor
- Improved fire resistance compared with plastic anchors

### Applications

- Fixing cables for suspended ceiling applications

### Installation

1. Drill a 8mm dia with 25mm depth hole.
2. Clean hole with hand pump.
3. Push anchor into the hole and hit with the hammer to obtain sufficient embedment (up to the widen part).