

## DynaBolt™ Sleeve Anchors

### The unique design of DynaBolt™

Twists, shortens and pulls down to increase holding power. For medium duty anchoring of timber and steel fixtures to concrete.



### Specification

- DynaBolt™ is a patented design sleeve anchor with the unique ability to "pull-down" and ensure a tight and secure anchoring of the fixture

### Substrates

- Concrete • Hollow brick • Solid block • Hollow block • Solid brick

### Head Styles



Hex Nut



Hex Bolt



Countersunk Head



Round Head

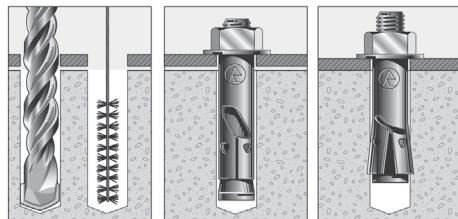

### Product Advantages

- Through fixing - no marking out and repositioning
- Variety of head styles
- Unique sleeve design collapses during tightening to provide pull-down onto fixture
- Integral nut and washer
- Finished head anchors, bolt can be easily removed

### Applications

- Timber to concrete, formwork, battens, bottom plates
- Services - Ductwork, pipe brackets, cable trays, suspended ceilings
- Metalwork - Signs, handrails, gates, drying rack (HKHA)
- Light to medium duty loading

### Installation

- Drill correct diameter hole and depth.
- Remove debris from hole by blowing out with compressed air or hand held blow out pump.
- Insert anchor through fixture and tap in until washer contacts fixture.
- Tighten bolt with a torque wrench to recommended tightening torque.

### DynaBolt™ - Zinc Cobalt Plated - Recommended Working Loads in 40N/mm<sup>2</sup> non-cracked Concrete

Anchor size (mm)	Thread Ø	Embedment Depth (mm)	Torque (Nm)	Shear Load (kN)*	Tensile Load (kN)*
6	M4.5	25	10	2.1	2.9
8	M6	30	10	3.3	3.8
10	M8	45	30	5.3	7.0
12	M10	55	40	6.6	9.5
16	M12	70	70	8.7	13.6
20	M16	85	150	13.0	18.2

\* Safety factor for all loads = 3

\* This table does not consider edge distance and anchor spacing effects. Please refer to Ramset Design Guide for more information.

### DynaBolt™ - Stainless Steel A4 316 - Recommended Working Loads in 40N/mm<sup>2</sup> non-cracked Concrete

Anchor size (mm)	Thread Ø	Embedment Depth (mm)	Torque (Nm)	Shear Load (kN)*	Tensile Load (kN)*
6	M4.5	25	10	1.4	2.9
8	M6	35	15	2.5	4.8
10	M8	45	35	4.5	7.0
12	M10	55	55	7.2	9.5

\* Safety factor for all loads = 3

\* This table does not consider edge distance and anchor spacing effects. Please refer to Ramset Design Guide for more information.

## DynaBolt™ Sleeve Anchor Hex Nut - Zinc Cobalt Plated



Part No.	Thread Ø	Max Fixture Thickness (mm)	Overall Anchor Length (mm)	Hole Ø (mm)	Fixture Hole Ø (mm)	Min Hole Depth (mm)	Effective Length (mm)	Order Qty
DP06040	M4.5	12	38	6	8	45	34	100
DP06060	M4.5	30	57	6	8	45	53	100
DP08040	M6	8	40	8	10	50	34	100
DP08065	M6	28	66	8	10	50	60	50
DP08090	M6	55	92	8	10	50	85	50
DP10040	M8	6	41	10	12	50	34	50
DP10050	M8	12	49	10	12	50	42	50
DP10075	M8	35	76	10	12	65	70	50
DP10100	M8	55	103	10	12	65	95	25
DP10125	M8	80	124	10	12	65	117	25
DP12060	M10	12	55	12	15	70	47	25
DP12070	M10	20	70	12	15	70	62	25
DP12100	M10	50	98	12	15	70	90	20
DP12125	M10	70	126	12	15	70	118	20
DP16065	M12	6	62	16	19	70	51	20
DP16110	M12	50	106	16	19	75	95	10
DP16140	M12	85	140	16	19	75	125	10
DP20080	M16	14	81	20	24	85	70	10
DP20115	M16	45	113	20	24	85	102	5
DP20160	M16	90	157	20	24	85	146	5

## DynaBolt™ Sleeve Anchor Hex Bolt - Zinc Cobalt Plated



Part No.	Thread Ø	Max Fixture Thickness (mm)	Overall Anchor Length (mm)	Hole Ø (mm)	Fixture Hole Ø (mm)	Min Hole Depth (mm)	Effective Length (mm)	Order Qty
DP08045H	M6	15	45	8	10	55	34	100
DP08070H	M6	32	70	8	10	55	60	50
DP10045H	M8	8	45	10	12	55	34	50
DP10055H	M8	20	55	10	12	55	42	50
DP10080H	M8	30	80	10	12	55	70	50
DP10105H	M8	60	105	10	12	55	95	25
DP12065H	M10	15	65	12	15	75	47	25
DP12075H	M10	20	75	12	15	75	62	25
DP12105H	M10	50	110	12	15	75	90	20
DP16070H	M12	12	70	16	19	75	51	20
DP16110H	M12	49	110	16	19	75	95	10

## DynaBolt™ Sleeve Anchor Countersunk Head - Zinc Plated



Part No.	Thread Ø	Max Fixture Thickness (mm)	Overall Anchor Length (mm)	Hole Ø (mm)	Fixture Hole Ø (mm)	Min Hole Depth (mm)	Effective Length (mm)	Order Qty
D6034F	M4.5	10	34	6	8	40	30	100
*DP06060F	M4.5	30	60	6	8	50	25	100
*DP06075F	M4.5	45	75	6	8	50	25	100
DP06100F	M4.5	70	100	6	8	60	25	100
DP08060F	M6	20	60	8	10	70	30	100
DP08085F	M6	45	85	8	10	75	30	50
DP10075F	M8	30	75	10	12	85	34	50
DP10100F	M8	55	100	10	12	85	34	50
DP10125F	M8	80	125	10	12	105	34	25

\* Also available in Stainless Steel Grade AISI 316 (A4) . Put SS after Part Number

## DynaBolt™ Sleeve Anchor Round Head - Zinc Plated



Part No.	Thread Ø	Max Fixture Thickness (mm)	Overall Anchor Length (mm)	Hole Ø (mm)	Fixture Hole Ø (mm)	Min Hole Depth (mm)	Effective Length (mm)	Order Qty
D6032R	M4.5	5	32	6	8	40	30	100
DP06055R	M4.5	25	55	6	8	50	25	100

**DynaBolt™ Sleeve Anchor Hex Nut - Hot Dip Galvanised**

Part No.	Thread Ø	Max Fixture Thickness (mm)	Overall Anchor Length (mm)	Hole Ø (mm)	Fixture Hole Ø (mm)	Min Hole Depth (mm)	Effective Length (mm)	Order Qty
DP10040GH	M8	6	41	10	12	50	34	50
DP10050GH	M8	12	49	10	12	50	42	50
DP10075GH	M8	35	76	10	12	50	70	50
DP10100GH	M8	55	103	10	12	50	95	25
DP12060GH	M10	12	55	12	15	70	47	25
DP12070GH	M10	20	70	12	15	70	62	25
DP12100GH	M10	50	98	12	15	70	90	20
DP12125GH	M10	70	126	12	15	70	118	20
DP16065GH	M12	6	62	16	19	70	51	20
DP16110GH	M12	50	106	16	19	75	95	10
DP16140GH	M12	85	140	16	19	75	125	10
DP20080GH	M16	14	81	20	24	85	70	5
DP20115GH	M16	45	113	20	24	85	102	5

**DynaBolt™ Sleeve Anchor Hex Nut - Stainless Steel Grade AISI 316 (A4)**

Part No.	Thread Ø	Max Fixture Thickness (mm)	Overall Anchor Length (mm)	Hole Ø (mm)	Fixture Hole Ø (mm)	Min Hole Depth (mm)	Effective Length (mm)	Order Qty
DP06040SS	M4.5	12	38	6	8	45	34	100
DP06060SS	M4.5	30	57	6	8	45	53	100
DP08040SS	M6	8	40	8	10	50	34	100
DP08065SS	M6	28	66	8	10	50	60	50
DP08090SS	M6	55	92	8	10	50	85	50
DP10050SS	M8	12	49	10	12	50	42	50
DP10075SS	M8	35	76	10	12	65	70	50
DP10100SS	M8	55	103	10	12	65	95	25
DP12060SS	M10	12	55	12	15	70	47	25
DP12070SS	M10	20	70	12	15	70	62	25
DP12100SS	M10	50	98	12	15	70	90	20
DP12125SS	M10	70	126	12	15	70	118	20

**DynaBolt™ Sleeve Anchor Hex Bolt - Stainless Steel Grade AISI 316 (A4)**

Part No.	Thread Ø	Max Fixture Thickness (mm)	Overall Anchor Length (mm)	Hole Ø (mm)	Fixture Hole Ø (mm)	Min Hole Depth (mm)	Effective Length (mm)	Order Qty
DP08045HSS	M6	15	45	8	10	55	34	100
DP08070HSS	M6	32	70	8	10	65	60	50
DP10045HSS	M8	8	45	10	12	55	34	50
DP10060HSS	M8	20	60	10	12	60	56	50
DP10080HSS	M8	30	80	10	12	80	70	50
DP10105HSS	M8	60	105	10	12	80	95	25
DP12075HSS	M10	20	75	12	15	75	62	25

**DynaBolt™ Specials**

Hookbolt Anchor



Eyebolt Anchor



Tie Wire Head

Part No.	Description	Thread Ø	Overall Anchor Length (mm)	Hole Ø (mm)	Fixture Hole Ø (mm)	Min Hole Depth (mm)	Order Qty
D08045K	D08045K Hookbolt Anchor	M6	31	8	-	40	100
D08045X	D08045X Eyebolt Anchor	M6	40	8	-	45	100
REM06	REM06 Tie Wire Head	M6	44	-	10	-	100
REM08	REM08 Tie Wire Head	M8	47	-	12	-	100
REM10	REM10 Tie Wire Head	M10	52	-	15	-	100

Note: Recommended Tensile Load of D08045K &amp; D08045X is 60 kg.

## EcBolt Sleeve Anchor

### EcBolt Sleeve Anchor best suit E & M applications

EcBolt is a torque setting expansion anchor, for medium duty anchoring of timber and steel fixture to concrete



#### Substrates

- Concrete • Solid brick • Solid block

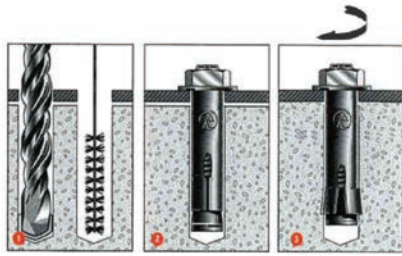

#### Product Advantages

- Through fixing - No marking out and repositioning
- Fully assembled
- Available with stud head & countersunk head style
- Integral nut and washer

#### Applications

- Services - duct work, pipe brackets, cable trays
- Metal Works - sign, handrail and gates
- Suspended ceilings bracket fixing
- Drywall track fixing
- Fastening light to medium weight equipment
- Bottom plate and batten fixing
- Fixing door frame (with countersunk head version)

#### Installation

1. Drill the correct diameter hole and depth. Clean hole thoroughly with brush and remove debris from hole by blowing out with compressed air or hand held blow out pump.
2. Insert anchor through fixture and tap in until washer contacts fixture.
3. Tighten bolt with a torque wrench to the recommended tightening torque.

### ECBOLT SLEEVE ANCHOR - Installation and Indicative Loadings

Part No.	Description	Thread Ø (mm)	Sleeve OD (mm)	Anchor Overall Length (mm)	Anchor Length below Washer (mm)	Fixture Thickness (mm)	Fixture Hole Ø (mm)	Embedment Depth (mm)	Drill Hole Ø (mm)	Min. Hole Depth (mm)	Torque (Nm)	Edge Distance (mm)	Anchor Spacing (mm)	Recommended Tensile Load @ ≥ C25 (kN)	Recommended Shear Load @ ≥ C25 (kN)
EC05025	6.5x25/5	M5	Ø6.5	31	25	5	8	17	Ø6.5	30	5	25	50	0.7	1.2
EC06040	8x40/12	M6	Ø8.0	47	40	12	10	25	Ø8.0	40	10	40	75	1.2	2.4
EC06055	8x55/27	M6	Ø8.0	62	55	27	10	25	Ø8.0	40	10	40	75	1.2	2.4
EC08050	10x50/12	M8	Ø10	56	50	12	12	31	Ø10	46	23	48	95	1.9	3.2
EC08075	10x75/37	M8	Ø10	87	75	37	12	31	Ø10	46	23	48	95	1.9	3.2
EC10060	12x60/16	M10	Ø12	70	60	16	14	36	Ø12	57	40	55	110	3.3	5.3
EC10075	12x75/31	M10	Ø12	85	75	31	14	36	Ø12	57	40	55	110	3.3	5.3
EC10100	12x100/56	M10	Ø12	110	100	56	14	36	Ø12	57	40	55	110	3.3	5.3
EC12075	16x75/16	M12	Ø16	88	75	16	18	49	Ø16	70	70	75	150	6.0	9.0
EC12100	16x100/41	M12	Ø16	113	100	41	18	49	Ø16	70	70	75	150	6.0	9.0
EC16110	20x110/43	M16	Ø20	126	110	43	22	55	Ø20	80	120	85	165	7.3	12.1

Recommended load stated in table has included a safety factor of 4.